

Installation / Maintenance Instructions

AUTOMATIC LINE DRAIN Series NL1

IS - NL1 - 2 - 01

Specification

Model	NL161
Port Size	G1/4
Condensate discharge capacity	60 ml / min.
Medium	Compressed air
Operating pressure range	2 - 10 bar (28 - 140 psi)
Ambient Temperature	5° - 60° C (41° - 140° F)
Installation	Vertical (as in the picture)
Materials of construction	Al, Brass, Nitrile, Acetal, Stainless Steel

Function

The Automatic Line Drain is of normally open, float type, mountable in main airline piping.

The valve closes at and above 2 bar *, and when the condensate level increases, the drain passage opens thus draining the condensate water.

When the condensate level decreases the drain passage closes.

* at a minimum flow of 100 lts/min in the mainline piping

Spare parts list

Description	Ordering No.
Drain assembly	SA2006
Bowl filter	752005
Piston assembly (15) (without Nutring (14))	SA2007
Service kit	SK2020

Service kit consists of the following:

'O' ring (3)	- 1 no.
Valve cone assembly (6)	- 1 no.
Spring (13)	- 1 no.
Nutring (14)	- 1 no.
'O' ring (19)	- 1 no.
'O' ring (20)	- 1 no.
'O' ring (21)	- 1 no.
Gland clip (22)	- 1 no.
Hose connector (23)	- 1 no.

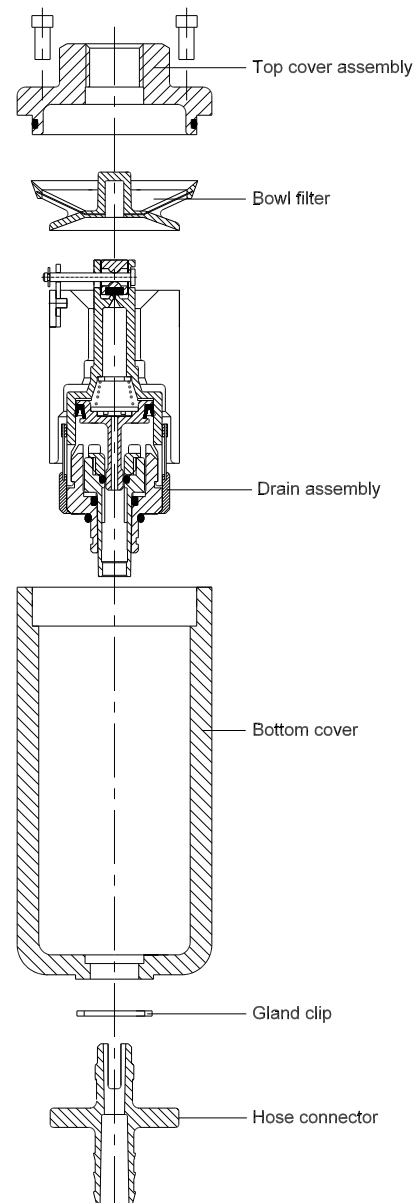

Fig. 1

Maintenance Instructions

AUTOMATIC LINE DRAIN Series NL1

IS - NL1 - 2 - 01

Trouble shooting

Trouble	Cause	Remedy
1. No draining of water	1. Bowl Filter (4) clogged 2. Drain Filter mesh (16) clogged 3. Orifice in the drain housing (11) gets clogged	Clean* & use Clean* & use Clean* & use / Clean* the Valve seat (9)
2. Continuous flow of air / water	1. Piston struck / Nutring (14) damaged 2. 'O'ring (19) damaged 3. 'O'ring (20) damaged 4. 'O'ring (21) damaged	Clean* / Replace Nutring (14) Clean* / Replace 'O'ring (19) Clean* / Replace 'O'ring (20) Clean* / Replace 'O'ring (21)

* Clean using air and soap water.

Dismantling / Assembly Instructions

(Ref: Fig. 1 & 2)

a. Dismantling Instructions

1. Completely exhaust the air in the pipe line.
2. **To dismantle the float, valve cone and Drain assembly**
 - i) Unscrew the bolts (2) to dismantle the Top cover (1) & Bottom cover (5) assembly
 - ii) Remove the Gland clip (21) and remove the Drain assembly from the Bottom cover.
 - iii) Remove the Clip (8) and Cross pin (7) to dismantle Float (10).
 - iv) Remove Valve cone assembly (6).
 - vi) Remove the Drain filter (16) (slide out)
 - vii) Dismantle the Drain housing (11) & Gland (18), taking care that the Spring (13) & Prefilter (12) does not fall off.
 - viii) Remove the Spring (13) and Piston assembly (15)
 - ix) Unscrew Adaptor nut (17) to remove 'O'ring (19)

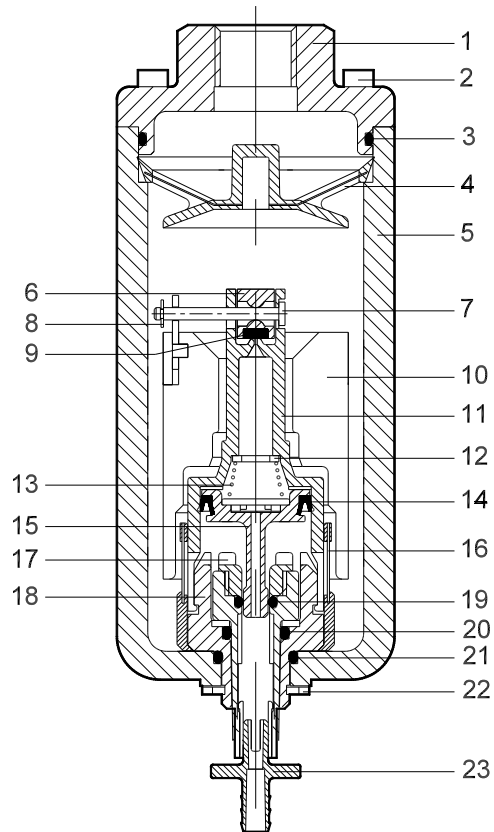

Fig. 2

b. Assembly Instructions

1. Ensure all components are clean and dirt free.
2. Apply general purpose grease on all 'O' rings and sealing areas.
3. **To Assemble the unit**, follow the above dismantling procedure in the reverse order